

Epower

True on-line UPS 3:1 phase
High output power factor 0.8



Highlights

- True Online double conversion
- Zero transfer time of output
- High reliability during operation
- Wide input frequency range
- Strong environmental adaptability
- Optimization of high performance
- Intelligent fan speed control
- Intelligent RS232 communication port
- SNMP adapter (optional)
- Strong Redundancy/Parallel ability
- Comprehensive and reliable protection
- User-friendly network management



■ High reliability on Design

- Double Conversion on-line design, which makes the output a pure sine wave source with tracking frequency, phase-lock and voltage regulation, noise suppression, and without power fluctuation interference, providing the load with more comprehensive protection.
- Zero transfer time of output, satisfy high standard power requirements of precision equipment.
- Modular design and dual-CPU control, high reliability and stability ensure the safe operation and high efficiency.

■ High reliability during operation

- Pure online static bypass technology, providing a strong protection against overload and fault.
- Wide input frequency range, ensure all types of fuel generators connected work stable.

Built-in manual maintenance bypass, further improving the reliability of continuous operation.

■ Strong environmental adaptability

- The range of AC input voltage is $380V \pm 20\%$, thereby reducing the battery using frequency and greatly extending the battery life.

■ Optimization of highperformance battery
 · Adapt intelligent battery management(ABM) technology, thus extending battery life and reducing battery maintenance times.

Advanced CC(constant current) / CV(constant voltage) auto-conversion charging technology maximizes the activation of cells, thus save charging time and extending the battery life.

■ Comprehensive and reliable protection
 Self-diagnosis function before start-up, avoid the risks that the failure may lead to.

· The multi-protections such as overload, short-circuit, over-temperature, battery under voltage, battery over-charge and so on greatly ensure the system stability and reliability.

■ Strong Redundancy/parallel ability
 · Some units can directly connected in parallel, increasing the scalability of the system.

· The parallel system can share a group of backup battery.

· Non-fixed Master-Slave relationship: Among the several UPS in parallel, the unit startup first is Master UPS, the others are Slave UPS. The master and slave can be exchanged. If the inverter of one UPS fails, the UPS will automatically cut off the output, then the load will be powered by remained UPS.

■ User-friendly network management
 · LCD accurately displays the status of operation and data for users.

· Communication with computer can be realized by RS232 with corresponding monitoring software. The various parameters can be shown on the communication interface.

· External SNMP adapter. The UPS with remote network management capability can provide real-time data for communication and management through a variety of network management systems.

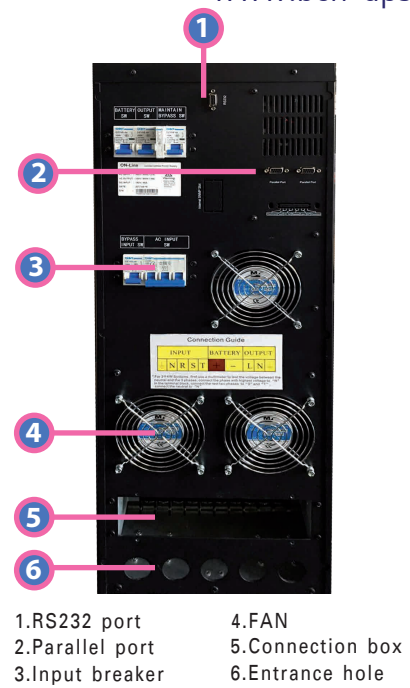

1.RS232 port 4.FAN
 2.Parallel port 5.Connection box
 3.Input breaker 6.Entrance hole

Epower 6-40KVA Three Phase/Single Phase

| Model | EPI6K | | | | | | |
|--------------------------|---|-------|-------|------------------|-------|------------------|------------------|
| Rated Capacity(VA) | 6kVA | 8kVA | 10kVA | 15kVA | 20kVA | 30kVA | 40kVA |
| Rated Power(W) | 4.8kW | 6.4kW | 8kW | 12kW | 16kW | 24kW | 32kW |
| Input | | | | | | | |
| Voltage range | 380Vac±20% (3p+N+PE) | | | | | | |
| Frequency range | 50/60Hz ±5% | | | | | | |
| Power factor | > 0.97 (withlter) | | | | | | |
| Max current | 14A | 18A | 23A | 34A | 45A | 68A | 90A |
| Output | | | | | | | |
| Voltage range | 220 Vac±1% | | | | | | |
| Frequency | 50Hz/60Hz±1% | | | | | | |
| Power factor | 0.8 | | | | | | |
| THD | Linear load < 1.5% | | | | | | |
| Overload | >125% / 1min, >150% / 200ms | | | | | | |
| Crest | 3 : 1 (max) | | | | | | |
| Efficiency (DC → AC) | > 90% | | | | | | |
| Transfer time | | | | | | | |
| Line mode → battery mode | 0ms | | | | | | |
| Battery | | | | | | | |
| DC voltage | 192VDC | | | 240VDC | | | |
| recharge time | 90% capacity after 8-10h charging | | | | | | |
| Display | | | | | | | |
| LED | Utility status \ inverter \ bypass \ battery status \ UPS abnormal \ overload | | | | | | |
| LCD | I/O voltage \ frequency \ battery voltage \ load \ internal temperature | | | | | | |
| Communication | | | | | | | |
| Interface | Dry contact RS232 Intelligent Monitoring Software | | | | | | |
| Operating Environment | | | | | | | |
| Temperature | 0 ~ 40 C | | | | | | |
| Humidity | 0 ~ 95% non condensing | | | | | | |
| Storage Temperature | -25 C ~ 55 C | | | | | | |
| Noise | < 55dB (1m) | | | | | | |
| Physical character | | | | | | | |
| Net Weight (Kg) | 105kg | 115kg | 125kg | 200kg | 235kg | 336kg | 371kg |
| Dimension (W × D × H)mm | 310 × 590 × 870 | | | 409 × 1044 × 798 | | 555 × 1200 × 741 | 600 × 1200 × 800 |
| Options | Input isolation transformer \ SNMP adapter \ Remote Control panel \ Harmonic lter | | | | | | |
| Standard | CE,EN/IEC 62040-2,EN/IEC 62040-1-1 | | | | | | |



- All specifications subject to change without notice.
- Custom-made specifications are acceptable.
- Manufactured by factory with ISO 9001, ISO 14001, OHSAS 18001, CE, STANDARD